



*2011 AWARDS*

# *The Categories*



1. Civic Organization
2. Business or Professional Organization
3. Government Entity
4. Tree Board of the Year
5. Outstanding Project
6. Tree Steward of the Year
7. Individual of the Year

# The Awards Committee



- Leigh Bangs-Volunteer; Indiana Community Tree Steward & Carmel Urban Forestry Committee
- Katie Booth-Horticulturist, Indianapolis Museum of Art
- Lee Huss-City Forester, Bloomington
- Pam Louks-C&UF Coordinator
- Anne Maschmeyer-Beautification Manager, Indianapolis Downtown, Inc.
- Ashley Mulis-Executive Director, IUFC
- Greg Shaner-Volunteer; Tree Lafayette and Indiana Community Tree Steward

# OUTSTANDING BUSINESS



*NIPSCO*

*&*

*LaPorte County Nursery*



LaPorte County  
Nursery

*Celebrating More Than Fifty Years  
In The Nursery Business*



**NIPSCO**

**RIGHT TREE  
RIGHT PLACE  
RIGHT WAY**



Related Links

**Trees for Energy Conservation Grant Program**





White County  
Nursery

*Celebrating More Than Fifty Years  
In The Nursery Business*



GARRISON  
CONFERENCE

# OUTSTANDING CIVIC ORGANIZATION



*INTERNATIONAL  
BROTHERHOOD  
OF  
ELECTRICAL WORKERS 697  
(IBEW LOCAL 697)*

# IBEW PROJECT

18 acre site with 11 acres woodland and pond.

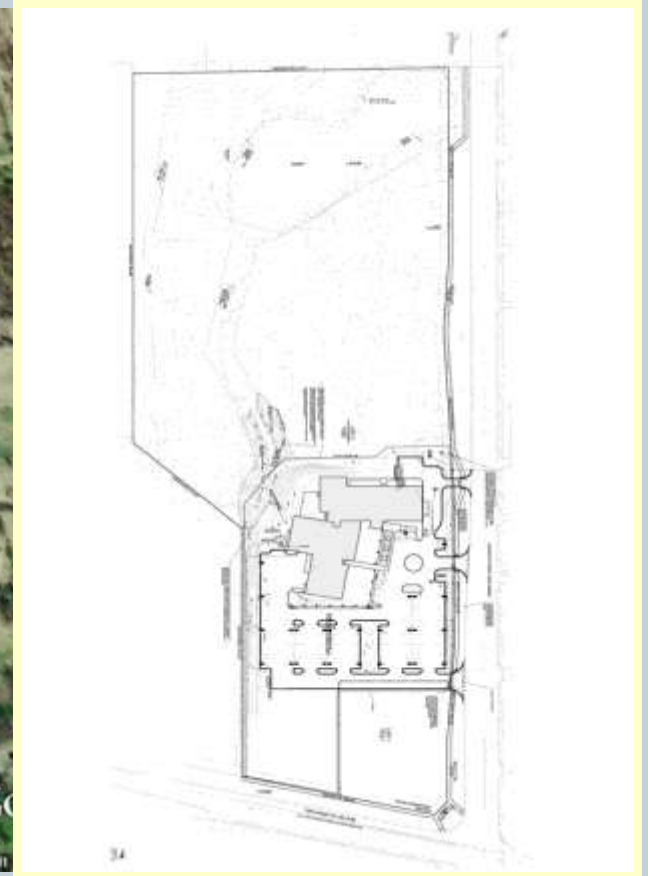

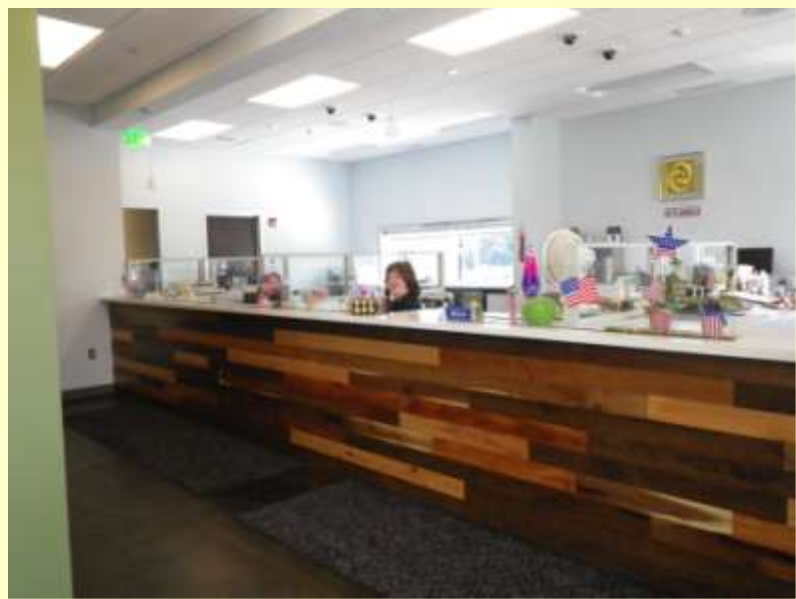

# GOVERNMENT



**City of Fort Wayne**  
**Indiana**

*FORT WAYNE*  
*EAB RESPONSE*



## Arrest That Pest!

EMERALD ASH BORER in Indiana

### THE CITY OF FORT WAYNE IS UNDER ATTACK

- we will lose thousands of Ash trees because of a tiny insect that is destroying an entire tree species. The Emerald Ash Borer is devouring a large portion of the Midwest's native Ash population. Entire neighborhoods have lost their beautiful tree-lined streets, which also affects property values and utility costs. **Tens of millions of trees have been killed throughout the Midwest so far...**

**One-fifth of Fort Wayne's street trees are Ash**, and we will probably lose most of them! The public is being asked to pitch in and help with the cost of saving what we can and replacing what we can't save. Donations are tax deductible and are greatly appreciated!

To correctly identify Ash trees, photograph the bark, leaves, form and branching from different viewpoints. Compare your pictures to Ash tree identification on the web at:

[www.EmeraldAshBorer.info/identifyashtree.cfm](http://www.EmeraldAshBorer.info/identifyashtree.cfm)

**Our city's tree canopy needs your generous support - we already have thousands of dead trees and will not be able to remove & replace them quickly enough without the public's help.**

**Donate to the Emerald Ash Borer Street Tree trust with the Parks & Recreation Department to remove and replace Ash street trees. Donate on-line at [www.fortwayneparks.org](http://www.fortwayneparks.org), or send a check to the Parks & Recreation Dept. at 705 E. State Blvd. FW, IN 46805 to Sarah Nichter's attention.**

**Questions about donating? Call Sarah Nichter at 427-6024 or email [sarah.nichter@cityoffortwayne.org](mailto:sarah.nichter@cityoffortwayne.org).**



City Forester:

Chad Tinkel  
Manager of Forestry Operations  
Fort Wayne Parks and Recreation  
1900 N. Clinton Street  
Fort Wayne, IN 46805  
260-427-6480  
e-mail: [chad.tinkel@cityoffortwayne.org](mailto:chad.tinkel@cityoffortwayne.org)





## Arrest That Pest! EMERALD ASH BORER

THE CITY OF FORT WAYNE IS  
ISSUES ATTACK

Emerald Ash Borer (EAB) is a highly destructive pest that has caused the death of millions of ash trees in the United States. The City of Fort Wayne is currently facing an EAB infestation and is seeking to raise awareness among residents and businesses about the pest and the importance of early detection and treatment.

Residents and businesses should look for signs of EAB infestation, such as dieback in the canopy, D-shaped exit holes in the bark, and S-shaped galleries in the bark. If you suspect you have an EAB infestation, please contact the City of Fort Wayne at (317) 434-2200 for more information.



GARRISON  
CONFERENCE  
CENTER

# OUTSTANDING PROJECT



*GREENDALE*

*ARBOR DAY EVENT*





INDIANA  
URBAN  
FOREST  
COUNCIL

2011  
Outstanding Project  
in Promoting the Principles  
of Urban Forestry in Indiana  
Greendale Arbor Day

• • •

21st ANNUAL CONFERENCE  
The Commons, Fort Harrison State Park Inc.  
October 18, 2011

JMPA

WALTER WHITE  
PRESIDENT

BARBARA  
CLARK

# TREE BOARD



## NORTH MANCHESTER TREE COMMITTEE

Town of North Manchester

*Indiana*







2011  
*Outstanding Tree Board*  
*in Promoting the Principles*  
*of Urban Forestry in Indiana*

**North Manchester**  
**Tree Commission**



21st ANNUAL CONFERENCE  
The Fairmont, Fort Harrison State Park Inn  
October 19, 2011

# TREE STEWARD

GREG SHANER







# INDIVIDUAL OF THE YEAR



Larry Rose

Tree Lafayette



## A thousand trees and counting

Tree Lafayette thanks the 157 volunteers who planted 61 trees on May 9 along Twyckenham Blvd. This planting and 36 trees planted later brings our total since 1994 to over 1,000 trees. President Larry Rose presented Mayor Tony Roswarski with a check for 1,000 trees that have been planted by Tree Lafayette since 1994.

The trees were funded with major grants from Alcoa, the Department of Natural Resources and Tipmont REMC EnviroWatts. Other contributors were: Community Foundation of Greater Lafayette, Eli Lilly, WLFI-TV 18, Duke Energy Foundation, Unitarian Universalist

ing us to park cars on their lot. Also we thank the neighborhood groups that helped plant for the first time, Wildcat Valley Estates, Ellsworth-Romig, Mill Creek, Potters Hollow, Indian Trails, etc., Alcoa, Caterpillar, WLFI-TV 18, Weed and Feed volunteers, Jefferson High School, Art of Living Purdue Student Club, Purdue University International Students and Scholars, Lafayette Park Department employees, Scout Troops 305 and 348 and pack 3348, and Senator Ron Alting for the Red Oaks.

**Larry L. Rose, president  
Tree Lafayette**





GARRISON  
CONFERENCE  
CENTER



# Lifetime Achievement Award

Pamela C. Louks

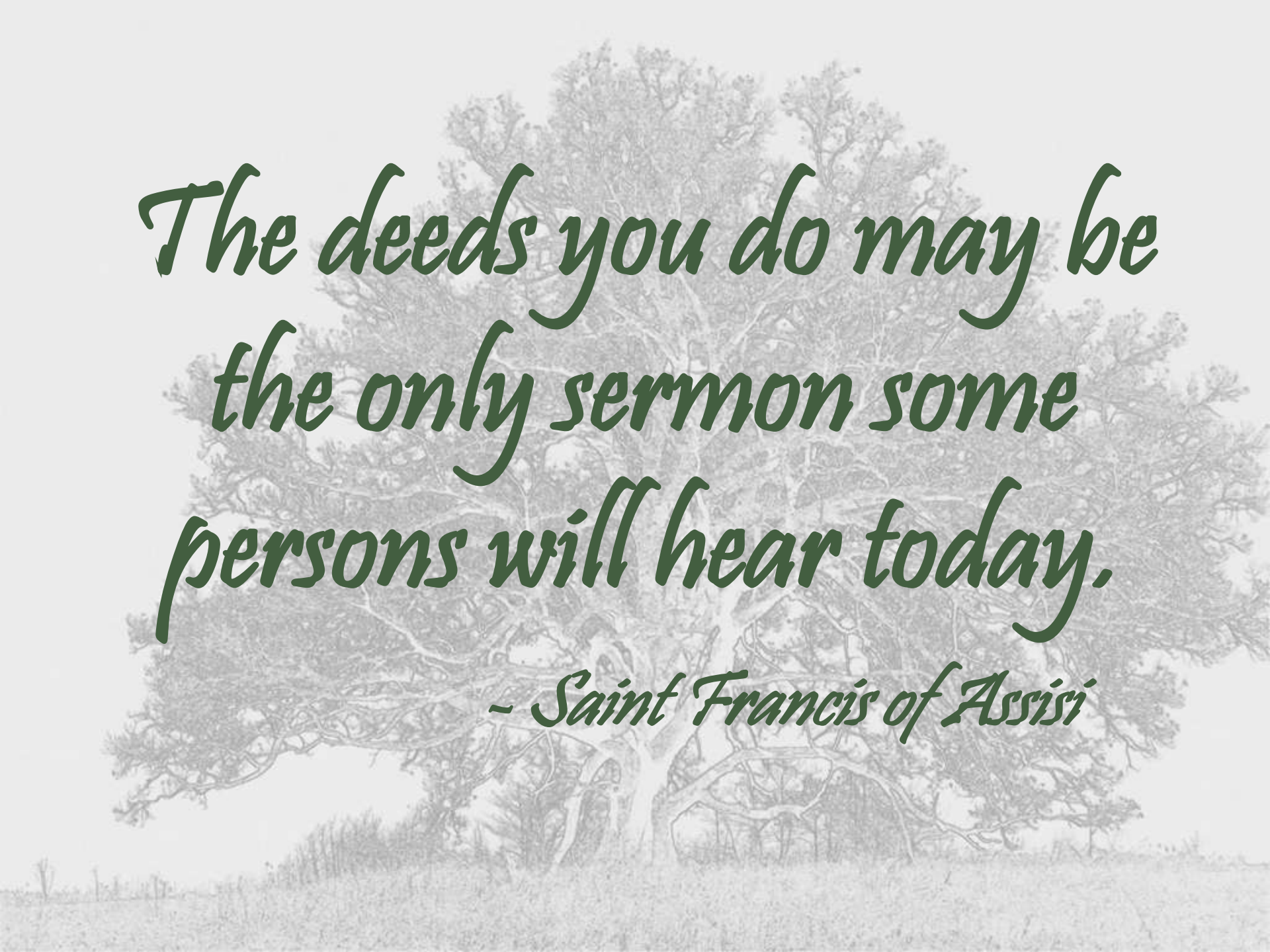

A large, gnarled tree with a thick trunk and dense foliage stands in a field. The tree is the central focus of the background image. The text is overlaid on the tree and the sky.

*The deeds you do may be  
the only sermon some  
persons will hear today.*

*- Saint Francis of Assisi*